

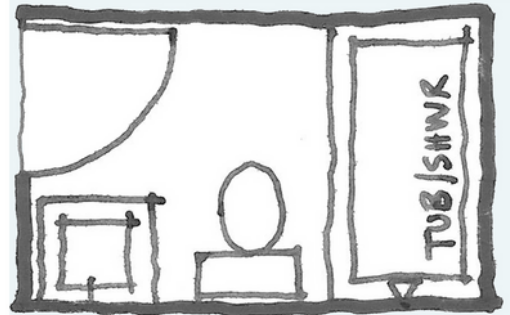

ABOUT THIS SERVICE



SPACE PLANNING

Whether you have an unfinished basement that you need help configuring or you would like to upgrade your entire floor; space planning is the service for you!

Out of all the skills in our toolbox, configuring spaces is our top area of expertise.

Space planning is a service that will provide you with multiple options of how to maximize every square inch

When configuring your space, we always take into account the various constraints such as structure, plumbing, electrical, budget and building code.

INCLUDED IN THIS PACKAGE

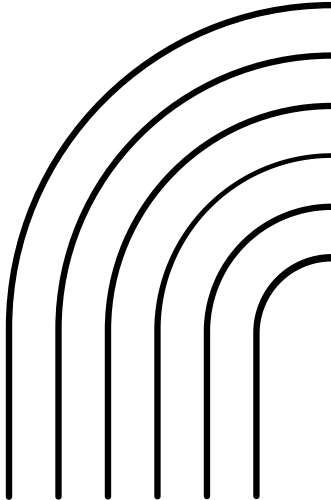
- On-site measurements
 - Multiple layout plans
 - Final layout plan
 - Showroom visits to source & quote all of the finishes
 - Lighting plan & electrical plan
 - 4 Revisions
- 

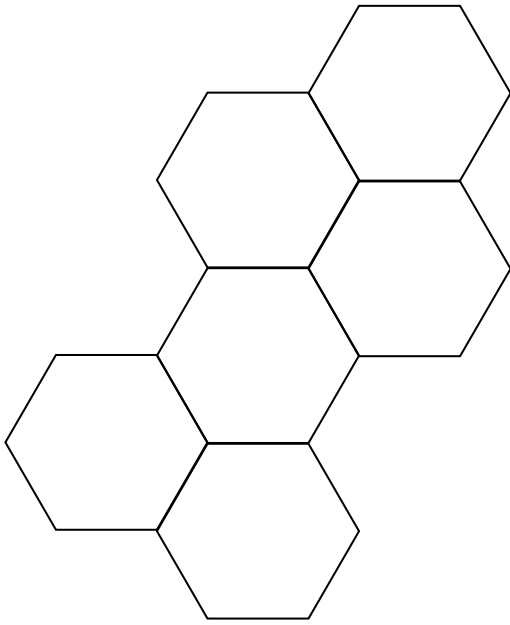

NEXT STEPS

01

Discovery Call

02

Fill Out the
Questionnaire

03

In-Person
Consultation

04

Deposit

05

Measurements
Take

06

Preliminary Design

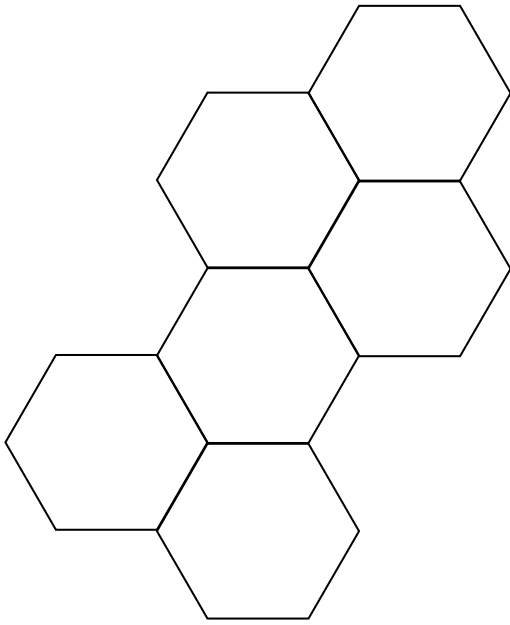

NEXT STEPS

07

**Scaled drawings of
Proposed Plans**

08

**Video Calls for
Multiple Revisions**

09

40% Installment

10

Final Revision

11

20% Balance